

HEAVY DUTY HYDRAULIC 4500lb CAR ROTISSERIE

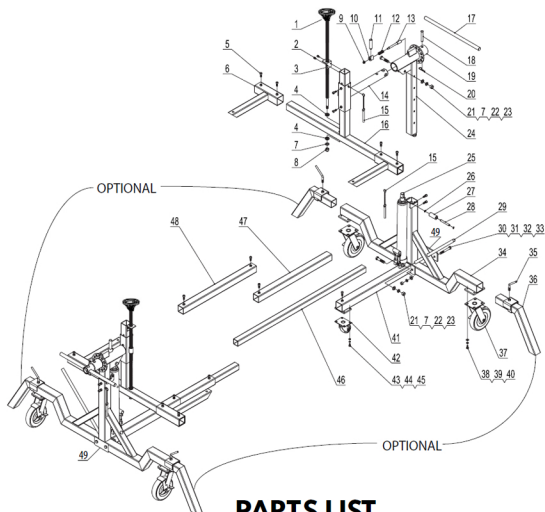

PARTS LIST

NO.	DESCRIPTION	QTY	NO.	DESCRIPTION	QTY
1	Adjust Screw Rod	2	25	Hydraulic Cylinder	2
2	Screw M8*12	4	26	Circlip	4
3	Screw Rod Stand	2	27	Guide Sleeve	2
4	Bearing	4	28	Guide Spindle	2
5	Screw M10*25	22	29	Operation Handle	2
6	Movable Stand	4	30	Bolt M14*100	4
7	Flat Washer Φ16	6	31	Flat Washer Φ14	4
8	Lock Nut M16	2	32	Lock Washer Φ14	4
9	Lock Nut M10	2	33	Lock Nut M14	4
10	Wedge Handle Seat	2	34	Main Stand	2
11	Handle	2	35	Set Screw	4
12	Spring	2	36	Steel Feet	4
13	Locking Pin	2	37	8" Caster	4
14	Rotating Stand	2	38	Bolt M10*20	16
15	Chain Pin	4	39	Lock Washer Φ10	16
16	Stand	2	40	Flat Washer Φ10	16
17	17 Turning Handle	2	41	Main Connecting Rod	2
18	Connecting Pin	2	42	3" Caster	2
19	Locking Plate	2	43	Bolt M8*16	8
20	R-pin	2	44	Lock Washer Φ8	8
21	Bolt M16*70	4	45	Flat Washer Φ8	8
22	Lock Washer Φ16	4	46	Extending Rod	2
23	Nut M16	4	47	Connecting Rod	2
24	Lifting Stand	2	48	Intermediate Connecting Rod	1
			49	Plate	2

DESCRIPTION

This product should be used for repairing and maintaining automobiles. The vehicle can be lifted 49" and rotated 360°.

SPECIFICATIONS

Max Height: 49"
Min Height: 21"
Max Length: 260"
Min Length: 121"

Width: 81"
Max Length Between Support Arms: 238"
Min Length Between Support Arms: 99"

SAFETY PRECAUTIONS

1. **DO NOT** exceed the rated capacity of 4,500 lb
2. Stay clear of the equipment when lifting or lowering
3. Keep the area around the equipment clear of obstacles
4. **ALWAYS** use the safety lock on the equipment

Prior to working with the rotisserie, always check for any obstructions that may interfere with the operation of the rotisserie such as: tools, air hoses, shop equipment, etc. These are generic instructions, please keep in mind there are different ways to hook up the same vehicle. Make sure to properly secure and balance vehicles center of gravity before using the rotisserie unit.

NOTE: There are no set rules when hooking up a vehicle. Make sure to utilize the structural mounting points on the vehicle.



CAUTION: IF YOU ATTEMPT TO ROTATE AN UNBALANCED VEHICLE YOU RISK INJURY, AN UNSAFE SITUATION, AND POSSIBLE DAMAGE TO YOUR VEHICLE.



WARNING: BEFORE OPERATING THE EQUIPMENT, MAKE SURE THAT ALL THE HARDWARE IS SECURE AND THAT EACH UNIT HAS BEEN TESTED PROPERLY.



WARNING: READ ENTIRE MANUAL AND COMPLY WITH ALL SAFETY AND SERVICE PRECAUTIONS. DEATH, PERSONAL INJURY AND / OR PROPERTY DAMAGE MAY OCCUR IF INSTRUCTIONS ARE NOT FOLLOWED CAREFULLY.

TOOLS

THE FOLLOWING TOOLS ARE NEEDED FOR PROPER ASSEMBLY

- | | |
|-----------------------|-------------------------------------|
| 1. Knife | 6. 24mm socket/wrench |
| 2. Ratchet | 7. 6mm allen wrench |
| 3. 13mm socket/wrench | 8. 8mm allen wrench |
| 4. 17mm socket/wrench | 9. 3" extension if using socket set |
| 5. 21mm socket/wrench | |

INSTALLATION

ASSEMBLY (REFER TO PARTS LIST)

1. Unpack all components
2. Attach one #41 Main Connecting Rod to each #34 Main Stand using hardware #30-33 – PLACE BOLTS THROUGH SUPPORT PLATE #49 PRIOR TO PUSHING THROUGH #34
3. Attach two #37 8" Casters to each #34 Main Stand using hardware #38-40
4. Attach one #42 3" Caster to each #41 Main Connecting Rod using hardware #43-45
5. Insert one #47 Connecting Rod into each #41 Main Connecting Rod
6. Insert one #46 Extending Rod into each #47 Connecting Rod
7. Insert the other end of each #46 Extending rod into #48 intermediate Connecting Rod
8. Attach one #25 Hydraulic Cylinder to each #34 Main Stand using hardware #7, 21-23
9. Insert one #24 Lifting Stand into each #34 Main Stand
10. Insert one #14 Rotating Stand into each #24 Lifting Stand
11. Slide one #19 Locking plate onto each #14 Rotating Stand and attach using hardware #18, 20
12. Remove hardware #4, 7, 8 from each #1 Adjust Screw Rod
13. Insert one #16 Stand into each #14 Rotating Stand
14. Place one set of hardware #7, 4, 7 onto #1 Adjust Screw Rod before pushing #1 through hole in #16 Stand
15. Place second set of hardware #7, 4, 7 onto #1 Adjust Screw Rod and secure using hardware #8 – **DO NOT OVERTIGHTEN**
16. Attach #3 Screw Rod Stand to #16 Stand using hardware #2
17. Slide two #6 Movable Stand onto each #16 Stand
18. Loosely attach twenty two #5 Screw into each respective set screw welded nut for use as needed
19. Re-check all hardware and test each #25 Hydraulic Cylinder prior to each use